

A - A

A - A

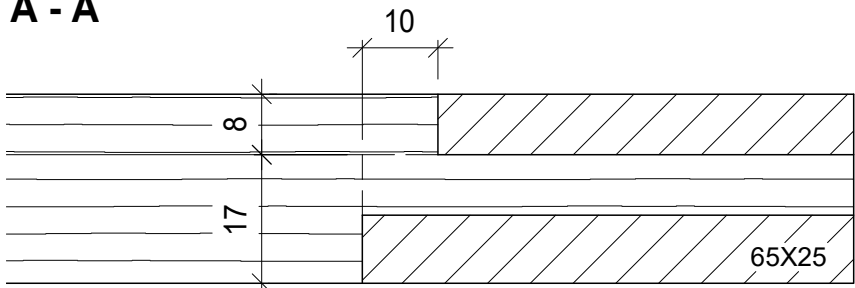

B - B

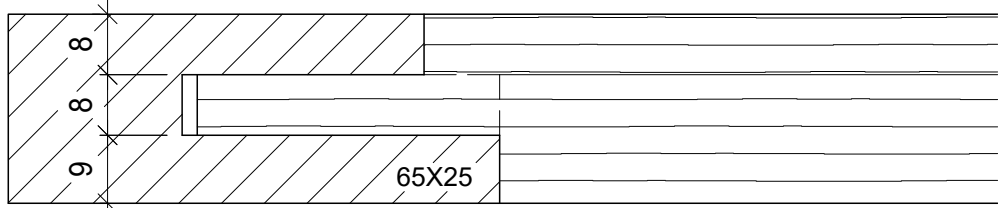
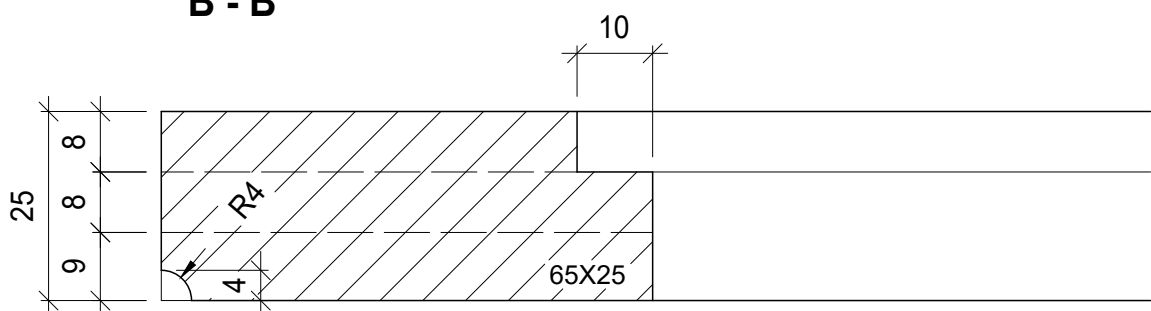

Vue de face

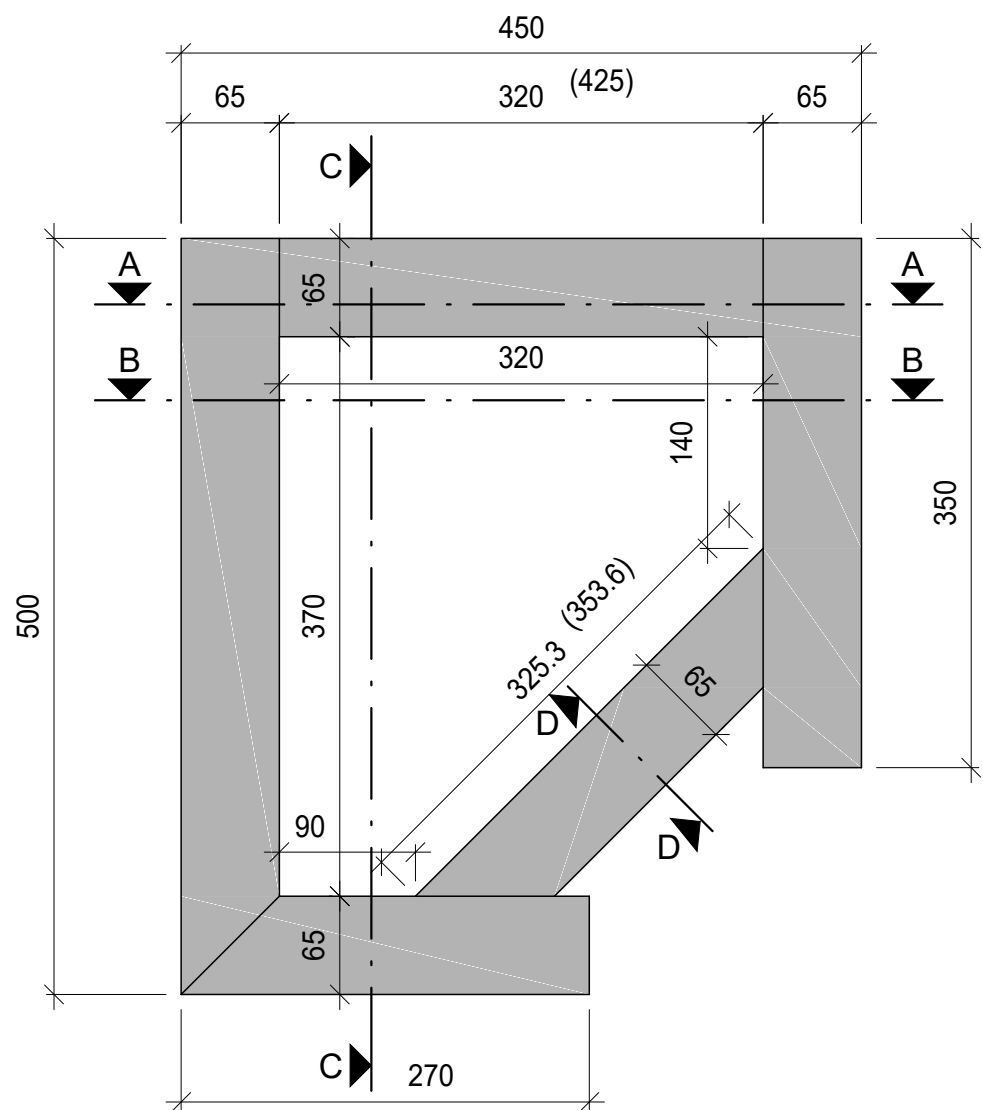

D - D

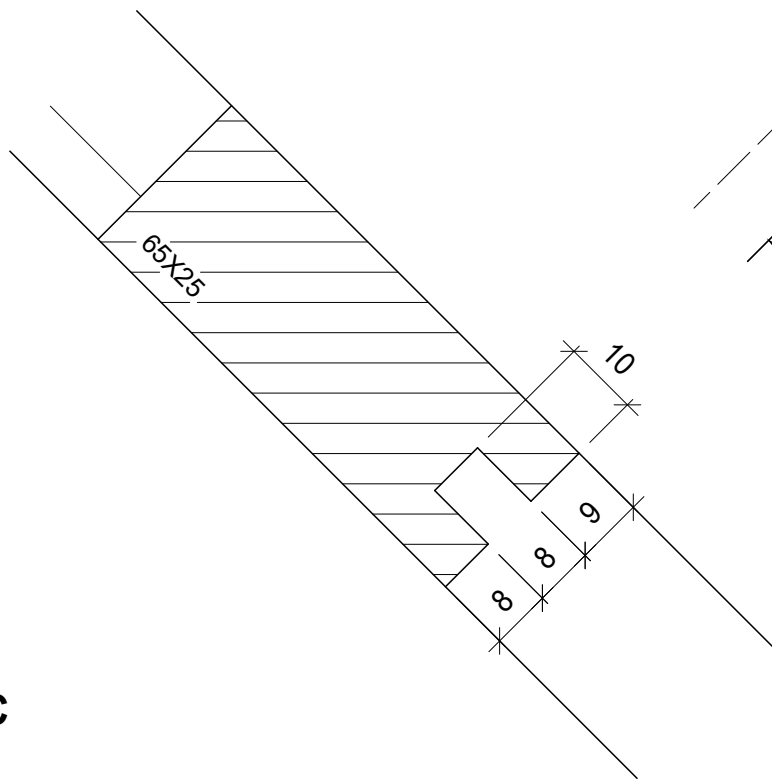

C - C

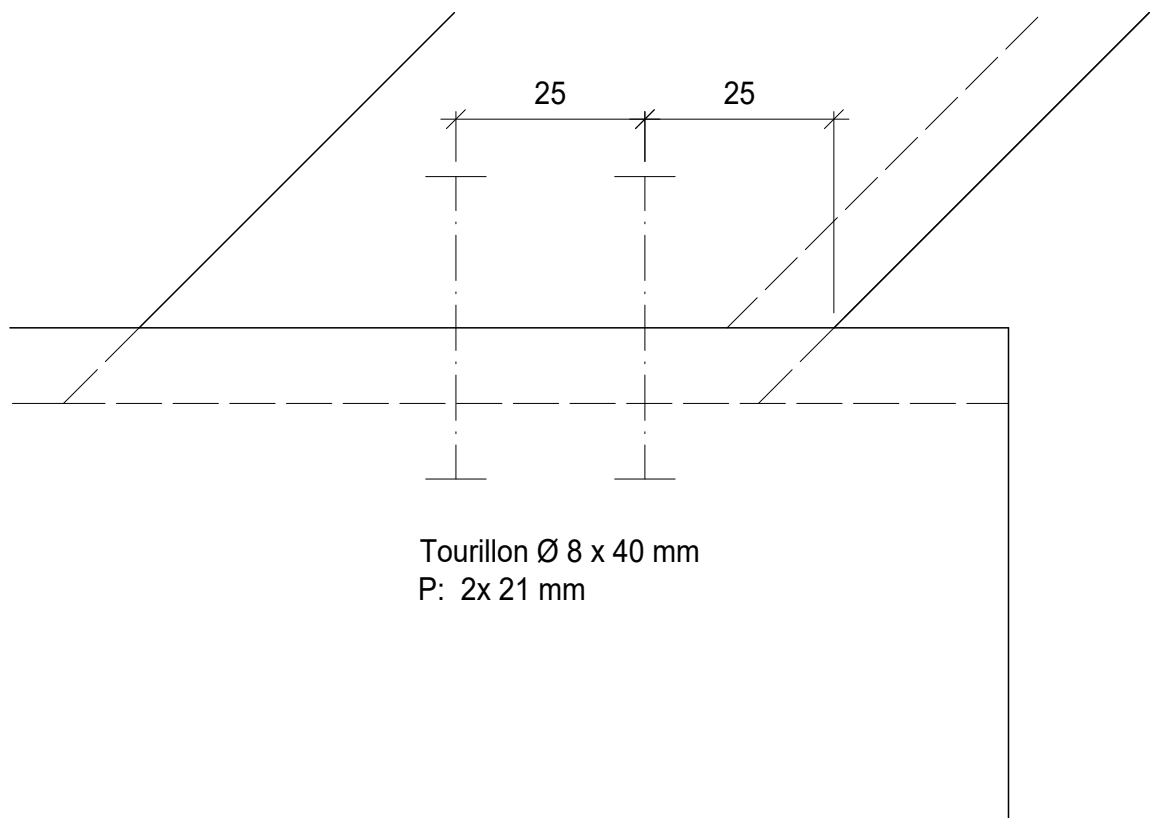
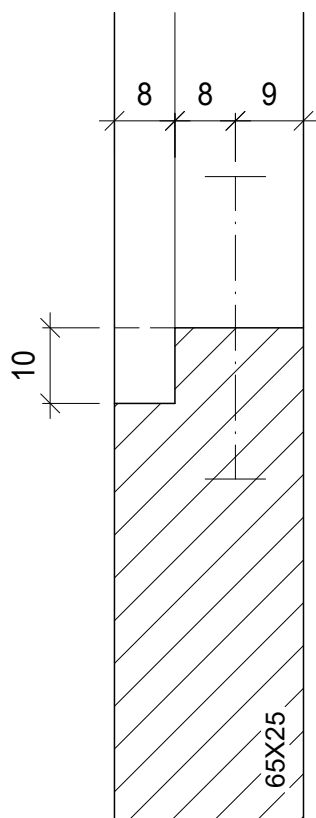

Temps : 60 minutes

Traçage pour l'exécution aux machines stationnaires (toupie, etc.)

Liste de matériaux	Mat.	Pce.	Long.	Larg.	Ep.
Montant gauche	SAP	1	500	65	25
Montant droite	SAP	1	350	65	25
Traverse haut	SAP	1	425	65	25
Traverse bas	SAP	1	270	65	25
Traverse en biais	SAP	1	353.6	65	25

11

Travail pratique
FRECEM
Travail pratique fondamental
(TPF) 6^e semestre
VSSM / FRECEM

Tâche N°:	18a_P_11
Echelle :	1:5 / 1:1
Format :	420 x 594
Date :	06.03.2018
Dessinateur :	ls oc